

Faithfully Stepping into the Future

Your Capital Campaign Team is actively building a financial plan to support these projects. A successful Capital Campaign is essential to bring these projects to life. The financial goal is to have no long-term debt upon project completion (short-term financing may be used during the process).

A three-year giving commitment to the Capital Campaign is needed to raise \$1,200,000, *in addition to your annual stewardship gifts*. We are asking for your consideration and commitment by August 1, 2025.

Watch your mail, e-mail, and social media for more information and how to pledge.

How can I give?

- Check, ACH, Credit Card
- Donate Stock
- Inheritance Money, Property
- IRA Charitable Rollover
- Required Minimum Distributions (RMDs)

All methods of giving are IRS tax-deductible and will appear on your giving statement.

When can I give?

- Your donation is welcome today.
- You can give monthly, quarterly, annually or in a lump sum.

Facilities Planning Team Members

- Michael Mourot (Lead, Facilitator)
- Jennifer Burkhart (Preschool Director)
- Susan Campbell (Project Management)
- Kristen Henninger (Project Management)
- Jim Hill (Electrical)
- Mike Kessler (Treasurer, Finances, Insurance)
- Paul Kethley (Sr Pastor)
- Steve Miller (Lay Leader)
- Whitney Reaves (Operations Director)
- Bill Tasto (Asset Management Lead)

Capital Campaign Steering Team Members

- Michael Mourot
- Brenda Habeck
- Mike Kessler
- Paul Kethley
- Steve Miller
- Whitney Reaves
- Patty Swords
- Diane Tasto

For questions, please contact the church office at:
(979) 297-7991 or
chapelwoodumc@chapelwoodumc.org

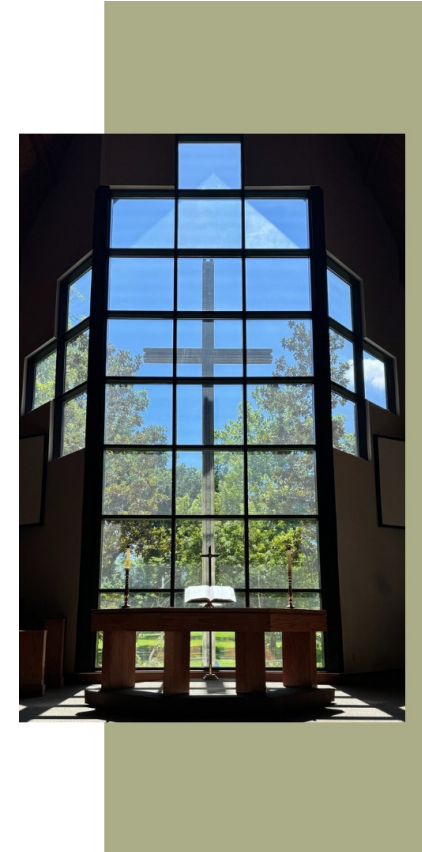

Faithfully Stepping Into the Future

- Welcoming
- Accessible
- Connected

Since its founding in 1962, Chapelwood has been blessed with beautiful property and facilities. As the church grew, the members of Chapelwood embraced the future with new facilities to support the mission of the church. Now it is our turn to **Faithfully Step Into The Future** by improving the facilities and making intentional changes that will enable Chapelwood to be more *Welcoming, Accessible and Connected* to the community we serve.

The Facilities Planning Team (FPT) has identified several areas for improvement. Below is a list of projects to be completed by 2027, including descriptions:

Parking Lot—A new parking lot including additional accessible parking spaces, new lights, and an upgraded traffic flow to improve safety.

Classrooms Remodel (400s)—In order to create functional space for growing class sizes and children, most of the classrooms in the 400s will be remodeled. The wall between 401 and 403 will be removed to make one large room. A new door will be installed to create access to a future fenced playground. What is currently the library will be enclosed to make an office for the Children and Family Ministries coordinator. The ceilings will be lowered in the new larger 401/403 room as well as 402 and 404. A new, more efficient, A/C system will be installed. The walls between 406 and 408 will be removed to create one large room.

Classrooms Remodel (400s)

Current

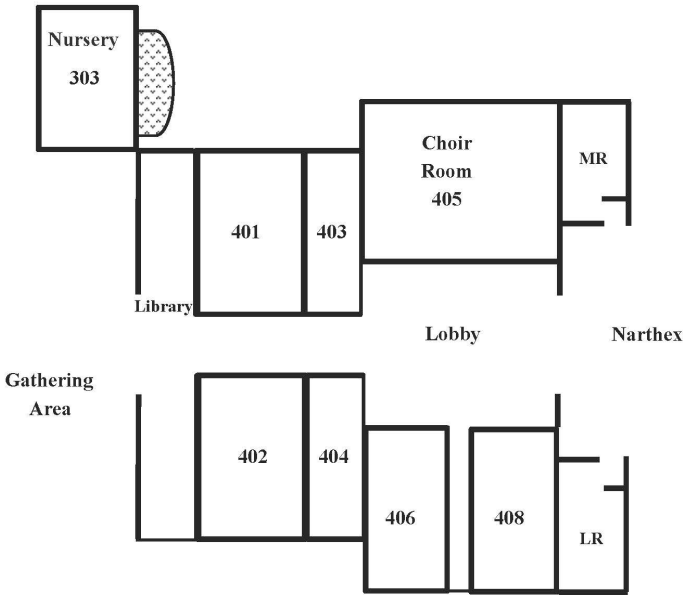

Proposed

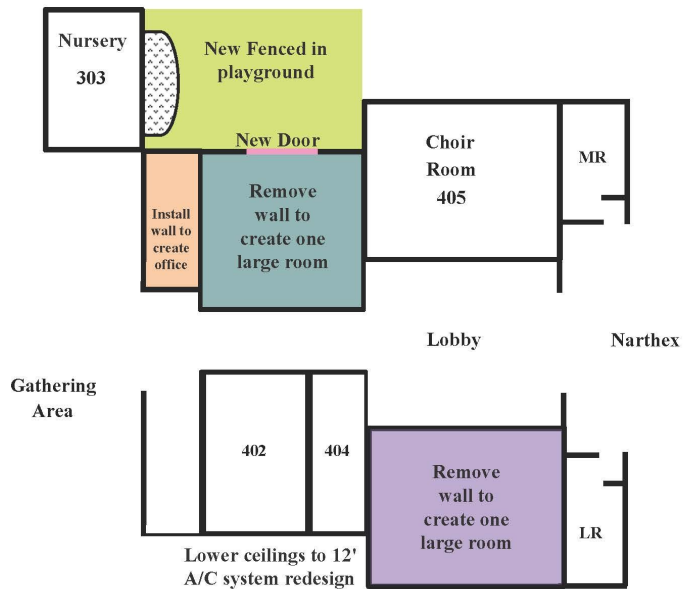

HVAC System Upgrade—As stated in the classroom remodel plans, the A/C system serving this portion of the building will be redesigned to be more efficient. In addition, we have many old A/C units that use R22, a refrigerant that is no longer produced and hard to find. These systems need to be upgraded to ensure we can continue operations.

Covered Drop Off—We will be adding a covered drop off to improve access to the building during adverse weather.

Sanctuary and Choir Loft Upgrades—The choir loft will be remodeled to improve safety and accessibility. The many levels of the current loft will be removed and the new loft will consist of 3 solid levels. The pews will be removed and chairs installed. The new layout will allow choir members to be able to hear each other and the piano better. It will also provide a flexible space that can be used for other music and worship experiences.

Electrical Rehab—Our electrical system is old and to make sure that we are able to operate with no interruption, it will require some maintenance work. All electrical services boxes will be inspected, cleaned and repaired.